

# Data Sheet

Item Code: **HVG**

Description: straight conduit gland, halogenfree

Properties: gland for corrugated conduits with patented plug-in system for quick-fit assembly with pull-tight connection

Colour: black, smiliar to RAL 9005

Thread Type Pg



Material	Protection Degree	Temperature Range	UV stabilisation
PPO	IP 54	-45 °C/+150 °C	yes

## Main Dimensions [mm]:

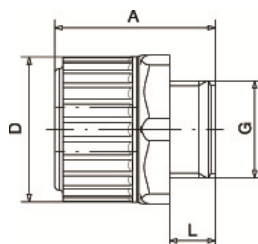

Nominal Size	G (Thread)	Thread Size	Wrench Size	L	A	D	Conduit Size
1207	Pg 7	12.6	21	8.0	18.3	21.0	12
1209	Pg 9	15.3	21	8.0	18.3	21.0	12
1609	Pg 9	15.3	25	10.5	18.9	24.7	16
1611	Pg 11	18.7	25	10.5	18.9	24.7	16
2011	Pg 11	18.7	30	12.0	24.0	29.8	20
2013	Pg 13.5	20.5	30	12.0	24.0	29.8	20
2516	Pg 16	22.6	38	14.5	30.4	37.2	25
3221	Pg 21	28.5	45	15.0	32.0	45.0	32
4029	Pg 29	37.2	57	15.0	38.0	56.2	40
5036	Pg 36	47.2	68	15.0	42.4	68.0	50
6348	Pg 48	59.5	82	20.0	54.0	82.0	63

All figures refer to standardised test samples and are given to our best knowledge but without further commitment. It is Univolt's belief that information set forth in this Data Sheet is accurate, Univolt makes no warranty, expressed or implied, with respect thereto and disclaims any liability from reliance thereon. All data are subject to change without prior notice.

**Package Quantity [pieces]:**

Nominal Size	Small Package	Large Package
1207	100	3,200
1209	50	2,000
1609	100	2,400
1611	100	2,400
2011	50	1,200
2013	50	1,200
2516	50	600
3221	30	360
4029	20	240
5036	16	128
6348	6	48

**Areas of Recommended Application**

Suitable for installation of corrugated conduits and connections with box entries.

# Data Sheet

Item Code: **HVG [dn] S**

Description: straight conduit gland, halogenfree

Properties: gland for corrugated conduits with patented plug-in system for quick-fit assembly with pull-tight connection and jetting water tight sealings

Colour: black, smiliar to RAL 9005

Thread Type Pg



Material	Protection Degree	Temperature Range	UV stabilisation
PPO	IP 65	-45 °C/+150 °C	yes

## Main Dimensions [mm]:

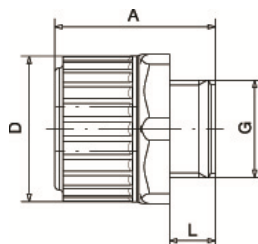

Nominal Size	G (Thread)	Thread Size	Wrench Size	L	A	D	Conduit Size
1207	Pg 7	12.6	21	8.0	18.3	21.0	12
1209	Pg 9	15.3	21	8.0	18.3	21.0	12
1609	Pg 9	15.3	25	10.5	18.9	24.7	16
1611	Pg 11	18.7	25	10.5	18.9	24.7	16
2011	Pg 11	18.7	30	12.0	24.0	29.8	20
2013	Pg 13.5	20.5	30	12.0	24.0	29.8	20
2516	Pg 16	22.6	38	14.5	30.4	37.2	25
3221	Pg 21	28.5	45	15.0	32.0	45.0	32
4029	Pg 29	37.2	57	15.0	38.0	56.2	40
5036	Pg 36	47.2	68	15.0	42.4	68.0	50
6348	Pg 48	59.5	82	20.0	54.0	82.0	63

All figures refer to standardised test samples and are given to our best knowledge but without further commitment. It is Univolt's belief that information set forth in this Data Sheet is accurate, Univolt makes no warranty, expressed or implied, with respect thereto and disclaims any liability from reliance thereon. All data are subject to change without prior notice.

**Package Quantity [pieces]:**

Nominal Size	Small Package	Large Package
1207	100	3,200
1209	50	2,000
1609	100	2,400
1611	100	2,400
2011	50	1,200
2013	50	1,200
2516	50	600
3221	30	360
4029	20	240
5036	16	128
6348	6	48

**Areas of Recommended Application**

Suitable for installation of corrugated conduits and connections with box entries.